



HIGH-PERFORMANCE ELECTRONIC SPEED CONTROL

FLETA PRO V2 1S ESC USER MANUAL

Thank you for purchase of Muchmore Racing FLETA PRO V2 1S electronic speed controller. New FLETA PRO V2 1S is specifically designed for 1/12 scale electric R/C racing. No matter which class of competition you race in, the FLETA PRO V2 1S will help you achieve better results. Before you start, please read through this instruction manual carefully. It contains important safety information as well as setup tips from Muchmore Racing website.

■ FEATURES ■

- 2 color LEDs for quick status display.
- Variable drive and brake frequency tuning for expert racing.
- Advanced boost and turbo timing with rpm and throttle control.
- Support for "Blinky" (Zero-Timing) spec racing mode.
- Fully configurable throttle and brake response.
- User adjustable low voltage and over temperature protection.
- Programmable by SHR program card & PC Interface.
- User upgradeable firmware.

BASIC INSTALLATION

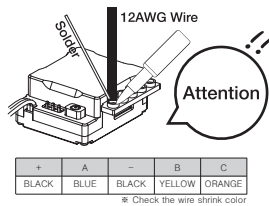
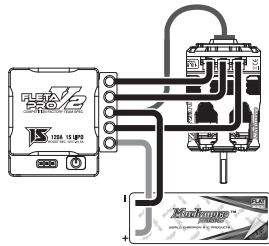

Pay special attention to the polarity marking below the mounting point. Make sure you connect each phase (A,B,C) of the motor to the corresponding (A,B,C) mounting point on the ESC. We recommend using a red color wire for the positive(+) battery input terminal, and a black color wire for the negative(-) terminal. Connecting a battery in reverse polarity will damage the ESC !!

Connection and Mounting

Connect the Rx connector to the throttle channel of your radio receiver.

(White Shrink tube is Signal wire)

Connect one end of the sensor cable to the motor's sensor port, and the other end to the ESC's sensor port. Secure the ESC and capacitor on your model car's chassis with double sided tape.

SAFETY INFORMATION

- Keep this product out of reach of children.
- This product is designed only for R/C car model use. It is not suitable for any other purpose.
- Never leave this product unattended while it is connected to a power source.
- Make sure all cables are in good condition and securely fastened.
- Keep in mind that vibration during operation may loosen connections and cause loss of control.
- Do not connect in reverse polarity.
- To prevent short-circuits, please make sure that all cables and connectors are properly insulated.
- Keep this product away from water, oil, fuel or other conductive liquids. If this product becomes damp, immediately stop using it and let it dry completely.
- Make sure to use suitable gear ratios for your track condition. Unsuitable gear ratios may overload and damage your speed controller and motor.
- Never operate with throttle when the motor has no load. Running the motor without load may cause damage and risk of fire or burn.

ESC Model	FLETA PRO V2 1S
Current Continuous / Burst	120A / 830A
Input	3-4 cells NiMH/NiCd or 1S LiPo
Built-in BEC	Super linear 6V@3.5A switching DC-DC booster
Suitable Motor	Over 3.0T
Suitable Car	1/12 scale on-road competition
Supported Motor Type	540 size 2 pole brushless with sensor type
Size	30.5mm(L) x 36.5mm(W) x 16.5mm(H)
Weight	39.6g (without Wire, Capacitor and Cooling fan)

POWERING ON FLETA

Always power ON your transmitter first before powering ON your ESC to avoid unexpected operation of the motor. For your safety, motor operation is automatically disabled until neutral throttle signal is detected from the radio receiver. Synchronizing the FLETA and Transmitter. In order for the ESC to recognize the full throttle range of your radio, a throttle range calibration is required. Before starting, make sure your radio throttle 2CH EPA and D/R is set at 100%. The trim and sub-trim should be zero.

Warning: To prevent any chance of loss of control or damage and injuries, make sure to remove the pinion gear from the motor during the calibration process!

The ESC must be calibrated to your transmitter inputs. Reset all settings inside the transmitter before the calibration.

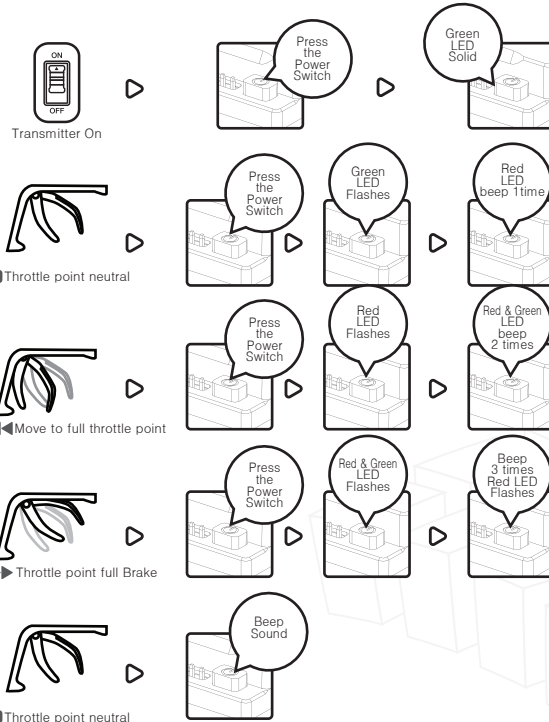

STEP 01. Calibration ready

1. Transmitter throttle EPA 100%, throttle point is neutral.
2. Press and hold the On/Off button for calibration mode.
3. Green LED with continous beep sound
4. Release the On/Off button.

STEP 02. Neutral setup

1. Throttle point is neutral
2. Press and release the On/Off button
3. Change red LED after green LED flashes. (beep sound 1 time)

STEP 03. Forward setup

1. Throttle point is forward (full throttle)
2. Press and release the On/Off button
3. Change red & green LED after red LED flashed. (beep sound 2 times)

STEP 04. Breck(Backward) setup

1. Throttle point is backward (full break)
2. Press and release the On/Off button
3. Change red LED after red & green LED flashed. (beep sound 3 times)

STEP 05. Setup finish

1. Throttle point is neutral
2. Finished calibration setting

LED STATUS INDICATOR

There are different color LED's on the face of the ESC for status indication. Please refer to following table for their meaning :

Green Solid All Color Solid Red Solid Green Flashing	Neutral Throttle Full Throttle / Reverse Full Brake Zero Timing Mode	Green solid / Red Flashing All Color Flashing Off the LED Red Flashing	Over Temperature Protection Activated No Sensor Cable Detected Power ON Without Signal From Receiver Motor connection error(A, B, C)
---	---	---	---

WARRANTY

Parts for defects and flaws of this product, please ask your dealer or distributor you purchased along with the receipt within 120 days from the date of original purchase.

The maximum amount of the above warranty, failure or defect normal wear and tear, incorrect use, due to improper repair or modification can not be guaranteed. This also applies to matters such as the following.

- If you are connected in reverse polarity of the product
- physical damage case
- physical damage of the electronic component and the circuit board (except soldering external) of the circuit board soldering
- Before the product for warranty service, please check how to resolve the problem before and all component parts.
- To obtain warranty service the product, you will need the receipt of the products you have purchased. (If you do not have a receipt, the warranty period not permitted.)
- Please fill in the address and contact details of the defect and the defect or repair or for faster delivery.

- product repair
- If the repair of the product, you will need a receipt at the time of purchase.
- For repair damaged parts, the cost of parts may be associated with each component will be charged.

MuchmoreRacing Co., Ltd.
127-1, Poong-dong, Ilisan-gu, Goyang-city, Gyeong-gi-do, 10300 Korea
Phone +82(31)903-0381 | Fax +82(31)903-0497
www.muchmoreracing.net

Muchmore™
RACING
WORLD CHAMPION R/C PRODUCTS